

20170301614

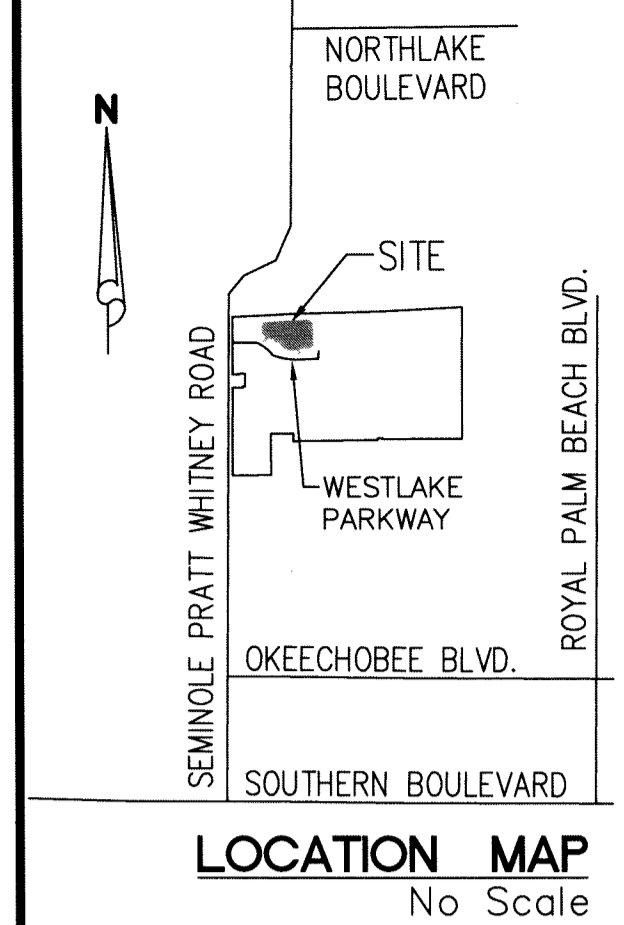

71
STATE OF FLORIDA }
COUNTY OF PALM BEACH } S.S.
THIS INSTRUMENT WAS FILED FOR RECORD AT 12:36 PM ON THIS 16th DAY OF AUGUST 2017 AND IS RECORDED IN PLAT BOOK NO. 217 ON PAGE 71-87
SHARON R. BOCK, CLERK AND COMPTROLLER
BY: *Maura K. Gordon*, D.C.

LOCATION MAP
No Scale

AREA TABULATION (IN ACRES)	
SINGLE FAMILY LOTS (211 LOTS):	39.90
TRACT "Q-2" (FUTURE DEVELOPMENT):	28.94
ROADWAY TRACTS (TRACT "A"):	12.68
OPEN SPACE TRACTS & RECREATION TRACTS:	2.37
WATER MANAGEMENT TRACTS:	27.92
WESTLAKE POD Q PHASE 1 P.L.U.D.:	111.81 TOTAL ACRES, MORE OR LESS

SURVEYORS NOTES

- PERMANENT REFERENCE MONUMENTS ARE SHOWN THUS: "■" A 1 1/2" BRASS DISK STAMPED "PRM LB7768" SET IN A 4"x4"x24" CONCRETE MONUMENT. PERMANENT CONTROL POINTS ARE SHOWN AS THUS: "●" A MAGNETIC NAIL AND DISK STAMPED "PCP LB7768". (UNLESS OTHERWISE NOTED)
- BEARINGS SHOWN HEREON ARE BASED ON THE NORTH BOUNDARY OF SECTION 6, TOWNSHIP 43 SOUTH, RANGE 41 EAST, HAVING A GRID BEARING OF S.89°48'33"E. BEARINGS SHOWN HEREON REFER TO THE STATE PLANE COORDINATE SYSTEM, NORTH AMERICAN DATUM OF 1983 (NAD 83 / 07) FOR THE EAST ZONE OF FLORIDA. SAID BASIS OF BEARING IS THE SAME IN THE NORTH AMERICAN DATUM OF 1983 (NAD 83 / 90).
- NO BUILDING OR ANY KIND OF CONSTRUCTION OR TREES OR SHRUBS SHALL BE PLACED ON ANY EASEMENT WITHOUT PRIOR WRITTEN CONSENT OF ALL EASEMENT BENEFICIARIES AND ALL APPLICABLE CITY OF WESTLAKE APPROVALS OR PERMITS AS REQUIRED FOR SUCH ENCROACHMENTS. THERE WILL BE NO ABOVE GROUND ENCROACHMENTS WHERE LAKE MAINTENANCE EASEMENTS AND UTILITY EASEMENTS COINCIDE.
- THE BUILDING SETBACKS SHALL BE AS REQUIRED BY THE CITY OF WESTLAKE ZONING REGULATIONS.
- NOTICE, THIS PLAT, AS RECORDED IN ITS GRAPHIC FORM, IS THE OFFICIAL DEPICTION OF THE SUBDIVIDED LANDS DESCRIBED HEREIN AND WILL IN NO CIRCUMSTANCES BE SUPPLANTED IN AUTHORITY BY ANY OTHER GRAPHIC OR DIGITAL FORM OF THE PLAT. THERE MAY BE ADDITIONAL RESTRICTIONS THAT ARE NOT RECORDED ON THIS PLAT THAT MAY BE FOUND IN THE PUBLIC RECORDS OF PALM BEACH COUNTY.
- IN THOSE CASES WHERE EASEMENTS OF DIFFERENT TYPES CROSS OR OTHERWISE COINCIDE, DRAINAGE EASEMENTS SHALL HAVE FIRST PRIORITY, UTILITY EASEMENTS SHALL HAVE SECOND PRIORITY, ACCESS EASEMENTS SHALL HAVE THIRD PRIORITY, AND ALL OTHER EASEMENTS SHALL BE SUBORDINATE TO THESE WITH THEIR PRIORITIES BEING DETERMINED BY USE RIGHTS GRANTED.
- ALL LINES INTERSECTING CIRCULAR CURVES ARE RADIAL UNLESS OTHERWISE NOTED.
- COORDINATES SHOWN HEREON ARE FLORIDA STATE PLANE GRID DATUM = NAD83 2007 ADJUSTMENT ZONE = FLORIDA EAST LINEAR UNITS = US SURVEY FEET COORDINATE SYSTEM = 1983 STATE PLANE PROJECTION = TRANSVERSE MERCATOR ALL DISTANCES ARE GROUND SCALE FACTOR: 1.0000 GROUND DISTANCE X SCALE FACTOR = GRID DISTANCE PLAT BEARING = GRID BEARING NO ROTATION ALL TIES TO SECTION CORNERS AND QUARTER CORNERS ARE GENERATED FROM MEASURED VALUES

SURVEYOR & MAPPER'S CERTIFICATE

THIS IS TO CERTIFY THAT THE PLAT SHOWN HEREON IS A TRUE AND CORRECT REPRESENTATION OF A SURVEY MADE UNDER MY RESPONSIBLE DIRECTION AND SUPERVISION, THAT SAID SURVEY IS ACCURATE TO THE BEST OF MY KNOWLEDGE AND BELIEF; THAT PERMANENT REFERENCE MONUMENTS ("P.R.M.S.") HAVE BEEN PLACED AS REQUIRED BY LAW, AND THAT PERMANENT CONTROL POINTS ("P.C.P.S.") AND MONUMENTS ACCORDING TO SEC. 177.091(9), F.S., WILL BE SET UNDER THE GUARANTEES POSTED WITH THE CITY OF WESTLAKE FOR THE REQUIRED IMPROVEMENTS; AND, FURTHER, THAT THE SURVEY DATA COMPLIES WITH ALL THE REQUIREMENTS OF CHAPTER 177, FLORIDA STATUTES, AS AMENDED, AND THE ORDINANCES OF CITY OF WESTLAKE, FLORIDA.

DATE: 06/21/2017

GARY A. RAGER, P.S.M.
LICENSE NO. LS4828
STATE OF FLORIDA

THIS INSTRUMENT PREPARED BY
GARY A. RAGER, P.S.M.
LS4828 STATE OF FLORIDA
GEOPoint SURVEYING, INC.
4152 WEST BLUE HERON BOULEVARD, SUITE 105,
RIVIERA BEACH, FLORIDA 33404.
CERTIFICATE OF AUTHORIZATION NO. LB7768

GeoPoint
Surveying, Inc.

4152 W. Blue Heron Blvd.
Suite 105
Riviera Beach, FL 33404

Phone: (561) 444-2720
www.geopointsurvey.com
Licensed Business Number LB 7768

SHEET 1 OF 11 SHEETS

HAMMOCKS OF WESTLAKE

BEING A REPLAT OF TRACT "Q" OF TOWN CENTER PARKWAY NORTH PER PLAT BOOK 123, PAGE 106-118, BEING A PORTION OF SECTION 6, TOWNSHIP 43 SOUTH, RANGE 41 EAST, AND A PORTION OF SECTION 1, TOWNSHIP 43 SOUTH, RANGE 40 EAST, CITY OF WESTLAKE, PALM BEACH COUNTY, FLORIDA

DEDICATION AND DESCRIPTION

KNOW ALL MEN BY THESE PRESENTS THAT MINTO PBLH, LLC, A FLORIDA LIMITED LIABILITY COMPANY, OWNER OF THE LAND SHOWN AND DESCRIBED HEREON AS HAMMOCKS OF WESTLAKE BEING A REPLAT OF TRACT "Q" OF TOWN CENTER PARKWAY NORTH PER PLAT BOOK 123, PAGE 106-118, BEING A PORTION OF SECTION 6, TOWNSHIP 43 SOUTH, RANGE 41 EAST, AND A PORTION OF SECTION 1, TOWNSHIP 43 SOUTH, RANGE 40 EAST, CITY OF WESTLAKE, PALM BEACH COUNTY, FLORIDA, BEING MORE PARTICULARLY DESCRIBED AS FOLLOWS:

DESCRIPTION:
A PARCEL OF LAND LYING IN SECTION 6, TOWNSHIP 43 SOUTH, RANGE 41 EAST, AND SECTION 1, TOWNSHIP 43 SOUTH, RANGE 40 EAST, CITY OF WESTLAKE, PALM BEACH COUNTY, FLORIDA, AND BEING MORE PARTICULARLY DESCRIBED AS FOLLOWS:

COMMENCE AT THE NORTHWEST CORNER OF SECTION 6, TOWNSHIP 43 SOUTH, RANGE 41 EAST; THENCE S.89°48'33"E. ALONG THE NORTH BOUNDARY OF SAID SECTION 6, A DISTANCE OF 1228.85 FEET; THENCE DEPARTING SAID NORTH BOUNDARY OF SECTION 6, S.00°11'07"W. A DISTANCE OF 950.00 FEET TO THE POINT OF BEGINNING; THENCE CONTINUE S.00°11'07"W., A DISTANCE OF 1149.14 FEET TO THE POINT OF CURVATURE OF A CURVE CONCAVE TO THE NORTHWEST WITH A RADIUS OF 300.00 FEET; THENCE SOUTHERLY AND SOUTHWESTERLY ALONG THE ARC OF SAID CURVE THROUGH A CENTRAL ANGLE OF 93°56'39", A DISTANCE OF 491.89 FEET TO THE POINT OF TANGENCY; THENCE N.85°52'14"W., A DISTANCE OF 95.80 FEET TO THE POINT OF CURVATURE OF A CURVE CONCAVE TO THE SOUTHWEST WITH A RADIUS OF 900.00 FEET; THENCE WESTERLY ALONG THE ARC OF SAID CURVE THROUGH A CENTRAL ANGLE OF 14°42'43", A DISTANCE OF 231.09 FEET TO THE POINT OF TANGENCY; THENCE S.79°25'03"W., A DISTANCE OF 212.12 FEET; THENCE S.10°34'57"E., A DISTANCE OF 16.21 FEET TO A NON-TANGENT INTERSECTION WITH A CURVE CONCAVE TO THE SOUTHWEST WITH A RADIUS OF 50.00 FEET AND A RADIAL BEARING OF S.34°15'58"E. AT SAID INTERSECTION; THENCE SOUTHERLY ALONG THE ARC OF SAID CURVE THROUGH A CENTRAL ANGLE OF 66°18'55", A DISTANCE OF 57.87 FEET TO THE POINT OF TANGENCY; THENCE S.10°34'53"E., A DISTANCE OF 194.04 FEET; THENCE S.55°34'57"E., A DISTANCE OF 25.41 FEET; THENCE S.10°34'57"E., A DISTANCE OF 12.00 FEET; THENCE S.79°25'03"W., A DISTANCE OF 160.53 FEET; THENCE N.10°34'57"W., A DISTANCE OF 11.41 FEET; THENCE N.34°25'03"E., A DISTANCE OF 26.24 FEET; THENCE N.10°34'53"W., A DISTANCE OF 194.03 FEET TO THE POINT OF CURVATURE OF A CURVE CONCAVE TO THE SOUTHWEST WITH A RADIUS OF 50.00 FEET; THENCE NORTHWESTERLY ALONG THE ARC OF SAID CURVE THROUGH A CENTRAL ANGLE OF 87°58'32", A DISTANCE OF 76.77 FEET TO A NON-RADIAL INTERSECTION THENCE N.10°34'57"W., A DISTANCE OF 12.03 FEET; THENCE S.79°25'03"W., A DISTANCE OF 229.25 FEET TO THE POINT OF CURVATURE OF A CURVE CONCAVE TO THE NORTHEAST WITH A RADIUS OF 500.00 FEET; THENCE SOUTHWESTERLY, WESTERLY AND NORTHWESTERLY ALONG THE ARC OF SAID CURVE THROUGH A CENTRAL ANGLE OF 55°34'57", A DISTANCE OF 485.05 FEET TO THE POINT OF TANGENCY; THENCE N.45°00'00"W., A DISTANCE OF 334.92 FEET TO THE POINT OF CURVATURE OF A CURVE CONCAVE TO THE SOUTHWEST WITH A RADIUS OF 500.00 FEET; THENCE NORTHWESTERLY ALONG THE ARC OF SAID CURVE THROUGH A CENTRAL ANGLE OF 15°00'00", A DISTANCE OF 130.90 FEET TO THE POINT OF TANGENCY; THENCE N.60°00'00"W., A DISTANCE OF 713.77 FEET; THENCE S.30°00'00"W., A DISTANCE OF 12.00 FEET; THENCE N.60°00'00"W., A DISTANCE OF 55.99 FEET TO THE POINT OF CURVATURE OF A CURVE CONCAVE TO THE SOUTHWEST WITH A RADIUS OF 50.00 FEET; THENCE NORTHWESTERLY, WESTERLY AND SOUTHWESTERLY ALONG THE ARC OF SAID CURVE THROUGH A CENTRAL ANGLE OF 76°34'01", A DISTANCE OF 66.82 FEET TO A NON-RADIAL INTERSECTION; THENCE S.33°56'02"W., A DISTANCE OF 70.07 FEET TO A RADIAL INTERSECTION WITH A CURVE CONCAVE TO THE SOUTHWEST WITH A RADIUS OF 1050.00 FEET; THENCE NORTHWESTERLY ALONG THE ARC OF SAID CURVE THROUGH A CENTRAL ANGLE OF 09°57'40", A DISTANCE OF 182.55 FEET TO A RADIAL INTERSECTION; THENCE N.23°58'21"E., A DISTANCE OF 65.00 FEET TO A RADIAL INTERSECTION WITH A CURVE CONCAVE TO THE NORTHWEST WITH A RADIUS OF 50.00 FEET AND A RADIAL BEARING OF N.23°58'21"E. AT SAID INTERSECTION; THENCE EASTERLY AND NORTHEASTERLY ALONG THE ARC OF SAID CURVE THROUGH A CENTRAL ANGLE OF 73°18'55", A DISTANCE OF 63.98 FEET TO THE POINT OF TANGENCY; THENCE N.40°39'26"E., A DISTANCE OF 52.49 FEET TO THE POINT OF CURVATURE OF A CURVE CONCAVE TO THE NORTHWEST WITH A RADIUS OF 90.00 FEET; THENCE NORTHWESTERLY ALONG THE ARC OF SAID CURVE THROUGH A CENTRAL ANGLE OF 54°30'35", A DISTANCE OF 8.56 FEET TO A POINT OF REVERSE CURVATURE WITH A CURVE CONCAVE TO THE SOUTHWEST WITH A RADIUS OF 76.00 FEET; THENCE NORTHERLY ALONG THE ARC OF SAID CURVE THROUGH A CENTRAL ANGLE OF 62°00'59", A DISTANCE OF 82.26 FEET TO THE POINT OF COMPOUND CURVATURE OF A CURVE CONCAVE TO THE SOUTHWEST WITH A RADIUS OF 347.20 FEET; THENCE NORTHEASTERLY ALONG THE ARC OF SAID CURVE THROUGH A CENTRAL ANGLE OF 05°28'04", A DISTANCE OF 33.13 FEET TO THE POINT OF REVERSE CURVATURE WITH A CURVE CONCAVE TO THE NORTHWEST WITH A RADIUS OF 50.00 FEET; THENCE NORTHERLY ALONG THE ARC OF SAID CURVE THROUGH A CENTRAL ANGLE OF 62°22'25", A DISTANCE OF 54.32 FEET TO A NON-TANGENT INTERSECTION; THENCE N.30°00'00"E., A DISTANCE OF 30.63 FEET; THENCE N.60°00'00"W., A DISTANCE OF 107.58 FEET TO THE POINT OF CURVATURE OF A CURVE CONCAVE TO THE NORTHEAST WITH A RADIUS OF 300.00 FEET; THENCE NORTHWESTERLY ALONG THE ARC OF SAID CURVE THROUGH A CENTRAL ANGLE OF 58°38'57", A DISTANCE OF 307.09 FEET TO THE POINT OF TANGENCY; THENCE N.01°21'03"W., A DISTANCE OF 254.57 FEET TO THE POINT OF CURVATURE OF A CURVE CONCAVE TO THE SOUTHWEST WITH A RADIUS OF 300.00 FEET; THENCE NORTHERLY AND NORTHEASTERLY ALONG THE ARC OF SAID CURVE THROUGH A CENTRAL ANGLE OF 89°58'00", A DISTANCE OF 471.06 FEET TO THE POINT OF TANGENCY; THENCE N.88°36'57"E., A DISTANCE OF 1694.77 FEET; THENCE S.89°48'33"E., A DISTANCE OF 919.94 FEET TO THE POINT OF CURVATURE OF A CURVE CONCAVE TO THE SOUTHWEST WITH A RADIUS OF 300.00 FEET; THENCE EASTERLY, SOUTHEASTERLY AND SOUTHERLY ALONG THE ARC OF SAID CURVE THROUGH A CENTRAL ANGLE OF 90°00'00", A DISTANCE OF 471.24 FEET TO THE POINT OF TANGENCY AND THE POINT OF BEGINNING.

CONTAINING 4,870,851 SQUARE FEET OR 111.81 ACRES MORE OR LESS.

DEDICATION:
TRACT "Q-2" AS SHOWN HEREON IS HEREBY RESERVED FOR MINTO PBLH, LLC, A FLORIDA LIMITED LIABILITY COMPANY, ITS SUCCESSORS AND ASSIGNS, FOR FUTURE DEVELOPMENT AND PURPOSES CONSISTENT WITH THE ZONING REGULATIONS OF THE CITY OF WESTLAKE, FLORIDA, AND IS THE PERPETUAL MAINTENANCE OBLIGATION OF SAID MINTO PBLH, LLC, ITS SUCCESSORS AND ASSIGNS, WITHOUT RECOURSE TO THE CITY OF WESTLAKE.

ROADS
TRACT "A" SHOWN HEREON AS KINGFISHER BOULEVARD, WHIPPOORWILL CIRCLE, RAIN LILLY WAY, BUTTONBUSH DRIVE, SWITCHGRASS LANE, AND QUAILBERRY DRIVE, ARE HEREBY DEDICATED TO THE HAMMOCKS OF WESTLAKE HOMEOWNERS ASSOCIATION, INC., ITS SUCCESSORS AND ASSIGNS, AS A PRIVATE ROADWAY FOR INGRESS AND EGRESS, ACCESS, UTILITIES AND DRAINAGE PURPOSES, AND SHALL BE THE PERPETUAL MAINTENANCE OBLIGATION OF SAID ASSOCIATION. AN EASEMENT OVER AND UNDER SAID TRACT "A" AS SHOWN HEREON IS ALSO RESERVED IN FAVOR OF THE SEMINOLE IMPROVEMENT DISTRICT, AN INDEPENDENT SPECIAL DISTRICT OF THE STATE OF FLORIDA, ITS SUCCESSORS AND ASSIGNS, FOR ACCESS TO, AND FOR THE INSTALLATION AND MAINTENANCE OF, PUBLIC UTILITY FACILITIES, INCLUDING BUT NOT LIMITED TO, WATER AND WASTEWATER LINES AND APPURTENANT FACILITIES AND THE INSPECTION, REPAIR, REPLACEMENT, UPGRADE AND MAINTENANCE OF WATER, WASTEWATER, AND WATER MANAGEMENT FACILITIES. AN EASEMENT OVER AND UNDER SAID TRACT "A" AS SHOWN HEREON IS ALSO RESERVED IN FAVOR OF THE CITY OF WESTLAKE FOR SERVICE VEHICLES AND EMERGENCY VEHICLES. THE CITY OF WESTLAKE AND THE SEMINOLE IMPROVEMENT DISTRICT, AN INDEPENDENT SPECIAL DISTRICT OF THE STATE OF FLORIDA, ITS SUCCESSORS AND ASSIGNS, SHALL NOT BE RESPONSIBLE FOR ANY MAINTENANCE OBLIGATIONS FOR SAID EASEMENT AREA OR SAID TRACT "A" EXCEPT AS SHALL RELATE TO THE SERVICING OF SUCH PUBLIC UTILITIES BY THE SEMINOLE IMPROVEMENT DISTRICT, AN INDEPENDENT SPECIAL DISTRICT OF THE STATE OF FLORIDA, ITS SUCCESSORS AND ASSIGNS, AND FOR MAINTENANCE AS IT RELATES TO THE CITY OF WESTLAKE'S SERVICE VEHICLES AND EMERGENCY VEHICLES.

OPEN SPACE TRACTS
TRACTS O.S.T. #1 THROUGH O.S.T. #13, INCLUSIVE, AS SHOWN HEREON, ARE HEREBY DEDICATED TO THE HAMMOCKS OF WESTLAKE HOMEOWNERS ASSOCIATION, INC., ITS SUCCESSORS AND ASSIGNS, FOR OPEN SPACE PURPOSES AND ARE THE PERPETUAL MAINTENANCE OBLIGATION OF SAID ASSOCIATION, ITS SUCCESSORS AND ASSIGNS, WITHOUT RECOURSE TO THE CITY OF WESTLAKE.

RECREATION TRACTS
TRACTS R.T. #1 THROUGH R.T. #5, INCLUSIVE, AS SHOWN HEREON, ARE HEREBY DEDICATED TO THE HAMMOCKS OF WESTLAKE HOMEOWNERS ASSOCIATION, INC., ITS SUCCESSORS AND ASSIGNS, FOR RECREATIONAL PURPOSES AND ARE THE PERPETUAL MAINTENANCE OBLIGATION OF SAID ASSOCIATION, ITS SUCCESSORS AND ASSIGNS, WITHOUT RECOURSE TO THE CITY OF WESTLAKE.

WATER MANAGEMENT TRACTS
TRACTS W.M.T. #1 THROUGH W.M.T. #6, INCLUSIVE, AS SHOWN HEREON, ARE HEREBY DEDICATED TO THE SEMINOLE IMPROVEMENT DISTRICT, AN INDEPENDENT SPECIAL DISTRICT OF THE STATE OF FLORIDA, ITS SUCCESSORS AND ASSIGNS, FOR STORMWATER MANAGEMENT AND DRAINAGE PURPOSES AND ARE THE PERPETUAL MAINTENANCE OBLIGATION OF SAID DISTRICT, ITS SUCCESSORS AND ASSIGNS, WITHOUT RECOURSE TO THE CITY OF WESTLAKE.

LAKE MAINTENANCE EASEMENTS
THE LAKE MAINTENANCE EASEMENTS (L.M.E.) AS SHOWN HEREON ARE HEREBY DEDICATED TO THE SEMINOLE IMPROVEMENT DISTRICT, AN INDEPENDENT SPECIAL DISTRICT OF THE STATE OF FLORIDA, ITS SUCCESSORS AND ASSIGNS, FOR ACCESS TO STORMWATER MANAGEMENT AND DRAINAGE FACILITIES LOCATED WITHIN THE ASSOCIATED WATER MANAGEMENT TRACTS FOR PURPOSES OF PERFORMING ANY AND ALL MAINTENANCE ACTIVITIES PURSUANT TO THE MAINTENANCE OBLIGATION OF SAID DISTRICT, ITS SUCCESSORS AND ASSIGNS, WITHOUT RECOURSE TO THE CITY OF WESTLAKE.

LAKE MAINTENANCE ACCESS EASEMENTS
THE LAKE MAINTENANCE ACCESS EASEMENTS (L.M.A.E.) AS SHOWN HEREON ARE HEREBY DEDICATED TO THE SEMINOLE IMPROVEMENT DISTRICT, AN INDEPENDENT SPECIAL DISTRICT OF THE STATE OF FLORIDA, ITS SUCCESSORS AND ASSIGNS, FOR ACCESS TO STORMWATER MANAGEMENT AND DRAINAGE FACILITIES LOCATED WITHIN THE ASSOCIATED WATER MANAGEMENT TRACTS FOR PURPOSES OF PERFORMING ANY AND ALL MAINTENANCE ACTIVITIES PURSUANT TO THE MAINTENANCE OBLIGATION OF SAID DISTRICT, ITS SUCCESSORS AND ASSIGNS, WITHOUT RECOURSE TO THE CITY OF WESTLAKE.

UTILITY EASEMENTS
ALL EASEMENTS DESCRIBED ON THE PLAT ARE PRIVATE NON-EXCLUSIVE EASEMENTS UNLESS EXPRESSLY STATED OTHERWISE THEREIN. ALL RIGHTS AND EASEMENTS ESTABLISHED BY OR RESERVED BY THIS PLAT ARE HEREBY RESERVED TO THE SEMINOLE IMPROVEMENT DISTRICT, (A LOCAL UNIT OF SPECIAL PURPOSE GOVERNMENT ESTABLISHED PURSUANT TO CHAPTERS 189 AND 298, FLORIDA STATUTES, AS A PUBLIC UTILITY PROVIDER OF WATER, SEWER AND RECLAIMED WATER), ITS SUCCESSORS AND ASSIGNS, SUBJECT TO THOSE CERTAIN RESTRICTION OF RIGHTS, COVENANTS AND DEDICATIONS AS MAY HEREAFTER BE IMPOSED BY GRANTOR; PROVIDED FURTHER SAID GRANTS OR ASSIGNMENTS SHALL NOT BE DEEMED A PUBLIC DEDICATION OF SAID RIGHTS OR EASEMENTS.

LIMITED ACCESS EASEMENTS
THE LIMITED ACCESS EASEMENTS (L.A.E.) AS SHOWN HEREON ARE HEREBY DEDICATED TO THE CITY OF WESTLAKE, FOR THE PURPOSE OF CONTROL AND JURISDICTION OVER ACCESS RIGHTS.

IN WITNESS WHEREOF, MINTO PBLH, LLC, A FLORIDA LIMITED LIABILITY COMPANY HAS CAUSED THESE PRESENTS TO BE SIGNED BY ITS MANAGER AND ITS COMPANY SEAL TO BE AFFIXED HERETO BY AND WITH THE AUTHORITY OF ITS MEMBERS THIS 20th DAY OF June, 2017.

WITNESS: *John F. Carter*
PRINT NAME: John F. Carter
JOHN F. CARTER, MANAGER

WITNESS: *Tara W. Dohy*
PRINT NAME: Tara W. Dohy

ACKNOWLEDGEMENT
STATE OF FLORIDA
COUNTY OF PALM BEACH

BEFORE ME PERSONALLY APPEARED JOHN F. CARTER WHO IS PERSONALLY KNOWN TO ME, OR HAS PRODUCED AS IDENTIFICATION, AND WHO EXECUTED THE FOREGOING INSTRUMENT AS MANAGER OF MINTO PBLH, LLC, A FLORIDA LIMITED LIABILITY COMPANY, AND SEVERALLY ACKNOWLEDGED TO AND BEFORE ME THAT HE EXECUTED SUCH INSTRUMENT AS SUCH OFFICER OF SAID COMPANY, AND THAT THE SEAL AFFIXED TO THE FOREGOING INSTRUMENT IS THE COMPANY SEAL OF SAID COMPANY, AND THAT IT WAS AFFIXED TO SAID INSTRUMENT BY DUE AND REGULAR COMPANY AUTHORITY, AND THAT SAID INSTRUMENT IS THE FREE ACT AND DEED OF SAID COMPANY.

WITNESS MY HAND AND OFFICIAL SEAL THIS 20th DAY OF June, 2017.

MY COMMISSION EXPIRES: 6-30-2020

Lynn Lo Brutto
NOTARY PUBLIC STATE OF FLORIDA

PRINT NAME: Lynn Lo Brutto
COMMISSION NO. FF 969599

LAKE MAINTENANCE ACCESS EASEMENTS
THE LAKE MAINTENANCE ACCESS EASEMENTS (L.M.A.E.) AS SHOWN HEREON ARE HEREBY DEDICATED TO THE SEMINOLE IMPROVEMENT DISTRICT, AN INDEPENDENT SPECIAL DISTRICT OF THE STATE OF FLORIDA, ITS SUCCESSORS AND ASSIGNS, FOR ACCESS TO STORMWATER MANAGEMENT AND DRAINAGE FACILITIES LOCATED WITHIN THE ASSOCIATED WATER MANAGEMENT TRACTS FOR PURPOSES OF PERFORMING ANY AND ALL MAINTENANCE ACTIVITIES PURSUANT TO THE MAINTENANCE OBLIGATION OF SAID DISTRICT, ITS SUCCESSORS AND ASSIGNS, WITHOUT RECOURSE TO THE CITY OF WESTLAKE.

DRAINAGE EASEMENTS
THE DRAINAGE EASEMENTS (D.E.) AS SHOWN HEREON ARE HEREBY DEDICATED IN PERPETUITY FOR DRAINAGE PURPOSES. THE MAINTENANCE OF ALL DRAINAGE FACILITIES LOCATED THEREIN SHALL BE THE PERPETUAL MAINTENANCE OBLIGATION OF THE SEMINOLE IMPROVEMENT DISTRICT, AN INDEPENDENT SPECIAL DISTRICT OF THE STATE OF FLORIDA, ITS SUCCESSORS AND ASSIGNS, WITHOUT RECOURSE TO THE CITY OF WESTLAKE.

CITY OF WESTLAKE SHALL HAVE THE RIGHT, BUT NOT THE OBLIGATION, TO MAINTAIN ANY PORTION OF THE DRAINAGE SYSTEM ENCOMPASSED BY THIS PLAT WHICH IS ASSOCIATED WITH THE DRAINAGE OF PUBLIC STREETS, INCLUDING THE RIGHT TO UTILIZE FOR PROPER PURPOSES ANY AND ALL DRAINAGE, LAKE MAINTENANCE, AND LAKE MAINTENANCE ACCESS EASEMENTS, AND PRIVATE STREETS ASSOCIATED WITH SAID DRAINAGE SYSTEM.

LIFT STATION EASEMENT
THE LIFT STATION EASEMENT IDENTIFIED ON THE PLAT HEREON IS AN EXCLUSIVE EASEMENT AND IS HEREBY DEDICATED IN PERPETUITY TO THE SEMINOLE IMPROVEMENT DISTRICT, AN INDEPENDENT SPECIAL DISTRICT OF THE STATE OF FLORIDA, ITS SUCCESSORS AND ASSIGNS, FOR THE INSTALLATION, OPERATION, MAINTENANCE, REPAIR, EXPANSION AND REPLACEMENT OF A WASTEWATER LIFT STATION AND RELATED APPURTENANCES. THE EASEMENT MAY BE FENCED IN BY THE SEMINOLE IMPROVEMENT DISTRICT FOR ACCESS CONTROL PURPOSES. THE MAINTENANCE OF THE UNFENCED PORTIONS OF THE LAND UNDERLYING THE EASEMENT SHALL BE THE PERPETUAL OBLIGATION OF THE PROPERTY OWNER. NO BUILDINGS, STRUCTURES, IMPROVEMENTS, TREES, WALLS OR FENCES SHALL BE INSTALLED WITHIN THIS TRACT(S) WITHOUT THE PRIOR WRITTEN APPROVAL OF THE SEMINOLE IMPROVEMENT DISTRICT, ITS SUCCESSORS AND ASSIGNS.

MINTO PBLH, LLC, A FLORIDA LIMITED LIABILITY COMPANY
WITNESS: *John F. Carter*
PRINT NAME: John F. Carter
JOHN F. CARTER, MANAGER

WITNESS: *Tara W. Dohy*
PRINT NAME: Tara W. Dohy

ACKNOWLEDGEMENT
STATE OF FLORIDA
COUNTY OF PALM BEACH

BEFORE ME PERSONALLY APPEARED JOHN F. CARTER WHO IS PERSONALLY KNOWN TO ME, OR HAS PRODUCED AS IDENTIFICATION, AND WHO EXECUTED THE FOREGOING INSTRUMENT AS MANAGER OF MINTO PBLH, LLC, A FLORIDA LIMITED LIABILITY COMPANY, AND SEVERALLY ACKNOWLEDGED TO AND BEFORE ME THAT HE EXECUTED SUCH INSTRUMENT AS SUCH OFFICER OF SAID COMPANY, AND THAT THE SEAL AFFIXED TO THE FOREGOING INSTRUMENT IS THE COMPANY SEAL OF SAID COMPANY, AND THAT IT WAS AFFIXED TO SAID INSTRUMENT BY DUE AND REGULAR COMPANY AUTHORITY, AND THAT SAID INSTRUMENT IS THE FREE ACT AND DEED OF SAID COMPANY.

WITNESS MY HAND AND OFFICIAL SEAL THIS 20th DAY OF June, 2017.

MY COMMISSION EXPIRES: 6-30-2020

Lynn Lo Brutto
NOTARY PUBLIC STATE OF FLORIDA

PRINT NAME: Lynn Lo Brutto
COMMISSION NO. FF 969599

ACCEPTANCE OF RESERVATIONS
STATE OF FLORIDA
COUNTY OF PALM BEACH

SEMINOLE IMPROVEMENT DISTRICT, AN INDEPENDENT SPECIAL DISTRICT OF THE STATE OF FLORIDA, HEREBY ACCEPTS THE DEDICATIONS AND RESERVATIONS TO SAID DISTRICT AS STATED AND SHOWN HEREON, AND HEREBY ACCEPTS ITS MAINTENANCE OBLIGATIONS FOR SAME AS STATED HEREON, DATED THIS 18th DAY OF July, 2017.

SEMINOLE IMPROVEMENT DISTRICT
AN INDEPENDENT SPECIAL DISTRICT OF THE STATE OF FLORIDA

WITNESS: *Scott Massey*
BY: *Ken Casse*
SCOTT MASSEY, PRESIDENT

PRINT NAME: Scott Massey

WITNESS: *Pam E. Booker*
PRINT NAME: PAM E. BOOKER

ACKNOWLEDGEMENT
STATE OF FLORIDA
COUNTY OF PALM BEACH

BEFORE ME PERSONALLY APPEARED SCOTT MASSEY WHO IS PERSONALLY KNOWN TO ME, OR HAS PRODUCED AS IDENTIFICATION, AND WHO EXECUTED THE FOREGOING INSTRUMENT AS PRESIDENT OF SEMINOLE IMPROVEMENT DISTRICT, AN INDEPENDENT SPECIAL DISTRICT OF THE STATE OF FLORIDA, HEREBY ACCEPTS SUCH INSTRUMENT AS SUCH OFFICER OF SAID DISTRICT, AND THAT THE SEAL AFFIXED TO THE FOREGOING INSTRUMENT IS THE DISTRICT SEAL OF SAID DISTRICT AND THAT IT WAS AFFIXED TO SAID INSTRUMENT BY DUE AND REGULAR DISTRICT AUTHORITY, AND THAT SAID INSTRUMENT IS THE FREE ACT AND DEED OF SAID DISTRICT.

WITNESS MY HAND AND OFFICIAL SEAL THIS 18th DAY OF July, 2017.

MY COMMISSION EXPIRES: 6-30-2020

Lynn Lo Brutto
NOTARY PUBLIC STATE OF FLORIDA

PRINT NAME: Lynn Lo Brutto
COMMISSION NO. FF 969599

ACCEPTANCE OF RESERVATIONS
STATE OF FLORIDA
COUNTY OF PALM BEACH

HAMMOCKS OF WESTLAKE HOMEOWNERS ASSOCIATION, INC., ITS SUCCESSORS AND ASSIGNS, HEREBY ACCEPTS THE DEDICATIONS AND RESERVATIONS TO SAID ASSOCIATION AS STATED AND SHOWN HEREON, AND HEREBY ACCEPTS ITS MAINTENANCE OBLIGATIONS FOR SAME AS STATED HEREON, DATED THIS 16th DAY OF August, 2017.

HAMMOCKS OF WESTLAKE HOMEOWNERS ASSOCIATION, INC.
AN INDEPENDENT CORPORATION
WITNESS: *John Carter*
BY: *John Carter*
JOHN CARTER, PRESIDENT

PRINT NAME: John Carter

WITNESS: *Tara W. Dohy*
PRINT NAME: Tara W. Dohy

ACKNOWLEDGEMENT
STATE OF FLORIDA
COUNTY OF PALM BEACH

BEFORE ME PERSONALLY APPEARED JOHN F. CARTER WHO IS PERSONALLY KNOWN TO ME, OR HAS PRODUCED AS IDENTIFICATION, AND WHO EXECUTED THE FOREGOING INSTRUMENT AS PRESIDENT OF HAMMOCKS OF WESTLAKE HOMEOWNERS ASSOCIATION, INC., A FLORIDA CORPORATION NOT FOR PROFIT, AND SEVERALLY ACKNOWLEDGED TO AND BEFORE ME THAT HE EXECUTED SUCH INSTRUMENT AS SUCH OFFICER OF SAID CORPORATION, AND THAT THE SEAL AFFIXED TO THE FOREGOING INSTRUMENT IS THE CORPORATE SEAL OF SAID CORPORATION AND THAT IT WAS AFFIXED TO SAID INSTRUMENT BY DUE AND REGULAR CORPORATION AUTHORITY, AND THAT SAID INSTRUMENT IS THE FREE ACT AND DEED OF SAID CORPORATION.

WITNESS MY HAND AND OFFICIAL SEAL THIS 16th DAY OF August, 2017.

MY COMMISSION EXPIRES: 6-30-2020

Lynn Lo Brutto
NOTARY PUBLIC STATE OF FLORIDA

PRINT NAME: Lynn Lo Brutto
COMMISSION NO. FF 969599

MORTGAGEE'S JOINDER AND CONSENT
STATE OF FLORIDA
COUNTY OF HILLSBOROUGH

THE UNDERSIGNED HEREBY CERTIFIES THAT IT IS THE HOLDER OF A MORTGAGE, UPON THE PROPERTY DESCRIBED HEREON AND DOES HEREBY JOIN IN AND CONSENT TO THE DEDICATION OF THE LAND DESCRIBED IN SAID DEDICATION BY THE OWNER THEREOF AND AGREES THAT ITS MORTGAGE WHICH IS RECORDED IN OFFICIAL RECORD BOOK 28283 AT PAGE(S) 1060 OF THE PUBLIC RECORDS OF PALM BEACH COUNTY, FLORIDA, SHALL BE SUBORDINATED TO THE DEDICATION SHOWN HEREON.

IN WITNESS WHEREOF, THE SAID CORPORATION HAS CAUSED THESE PRESENTS TO BE SIGNED BY ITS VICE PRESIDENT THIS 17th DAY OF July, 2017.

WITNESS: *Linda Boat*
BY: *Beverly J. Matter*
LINDA BOAT, VICE PRESIDENT
BEVERLY J. MATTER, VICE PRESIDENT

PRINT NAME: Linda Boat
PRINT NAME: Beverly J. Matter

ACKNOWLEDGEMENT
STATE OF FLORIDA
COUNTY OF HILLSBOROUGH

BEFORE ME PERSONALLY APPEARED BEVERLY J. MATTER (PRINTED NAME) WHO IS PERSONALLY KNOWN TO ME, OR HAS PRODUCED AS IDENTIFICATION, AND WHO EXECUTED THE FOREGOING INSTRUMENT AS VICE PRESIDENT OF WELLS FARGO BANK, NATIONAL ASSOCIATION, A NATIONAL BANKING ASSOCIATION, AND ACKNOWLEDGED TO AND BEFORE ME THAT [HE] [SHE] EXECUTED SUCH INSTRUMENT AS SUCH OFFICER OF SAID ASSOCIATION, AND THAT SAID INSTRUMENT IS THE FREE ACT AND DEED OF SAID ASSOCIATION.

WITNESS MY HAND AND OFFICIAL SEAL THIS 17th DAY OF July, 2017.

MY COMMISSION EXPIRES: 2/20/17

Lynn Lo Brutto
NOTARY PUBLIC STATE OF FLORIDA

PRINT NAME: Lynn Lo Brutto
COMMISSION NO. FF 969599

CITY OF WESTLAKE'S APPROVAL:
THIS CERTIFIES THAT THIS PLAT HAS BEEN ACCEPTED AND APPROVED BY THE CITY COUNCIL FOR THE CITY OF WESTLAKE BY A RESOLUTION FULLY ADOPTED BY THE CITY COUNCIL THIS 12 DAY OF June, 2017, IN ACCORDANCE WITH SEC. 177.07(1)(2), F.S., AND HAS BEEN REVIEWED BY A PROFESSIONAL SURVEYOR & MAPPER EMPLOYED BY THE CITY OF WESTLAKE IN ACCORDANCE WITH SEC. 177.08(1), F.S.

Ken Casse
CITY MANAGER, KEN CASSE

Roger Manning
CITY MANAGER, ROGER MANNING

TITLE CERTIFICATION
STATE OF FLORIDA
COUNTY OF Broward

WE, FOUNDERS TITLE, A TITLE INSURANCE COMPANY, AS DULY AUTHORIZED TO DO BUSINESS IN THE STATE OF FLORIDA DO HEREBY CERTIFY THAT WE HAVE EXAMINED THE TITLE TO THE HEREON DESCRIBED PROPERTY; THAT WE FIND THE TITLE TO THE PROPERTY IS VESTED IN MINTO PBLH, LLC (S) OF OWNER (S); THAT THE CURRENT TAXES HAVE BEEN PAID; AND THAT ALL PALM BEACH SPECIFIC ENCUMBRANCE ITEMS, AND ALL OTHER ITEMS HELD AGAINST SAID LANDS HAVE BEEN SATISFIED; THAT [ALL MORTGAGES NOT SATISFIED OR OTHERWISE TERMINATED BY LAW ARE SHOWN HEREON] [THERE ARE NO MORTGAGES OF RECORD]; AND THAT [THERE ARE NO OTHER ENCUMBRANCES OF RECORD] [THERE ARE ENCUMBRANCES OF RECORD BUT THOSE ENCUMBRANCES DO NOT PROHIBIT THE CREATION OF THE SUBDIVISION DEPICTED BY THIS PLAT].

DATED: 07/06/2017

HARRY WATKINS, PRESIDENT, FOUNDERS TITLE

ACKNOWLEDGEMENT
STATE OF FLORIDA
COUNTY OF PALM BEACH

BEFORE ME PERSONALLY APPEARED SCOTT MASSEY WHO IS PERSONALLY KNOWN TO ME, OR HAS PRODUCED AS IDENTIFICATION, AND WHO EXECUTED THE FOREGOING INSTRUMENT AS PRESIDENT OF SEMINOLE IMPROVEMENT DISTRICT, AN INDEPENDENT SPECIAL DISTRICT OF THE STATE OF FLORIDA, HEREBY ACCEPTS SUCH INSTRUMENT AS SUCH OFFICER OF SAID DISTRICT, AND THAT THE SEAL AFFIXED TO THE FOREGOING INSTRUMENT IS THE DISTRICT SEAL OF SAID DISTRICT AND THAT IT WAS AFFIXED TO SAID INSTRUMENT BY DUE AND REGULAR DISTRICT AUTHORITY, AND THAT SAID INSTRUMENT IS THE FREE ACT AND DEED OF SAID DISTRICT.

WITNESS MY HAND AND OFFICIAL SEAL THIS 18th DAY OF July, 2017.

MY COMMISSION EXPIRES: 6-30-2020

Lynn Lo Brutto
NOTARY PUBLIC STATE OF FLORIDA

PRINT NAME: Lynn Lo Brutto
COMMISSION NO. FF 969599

ACKNOWLEDGEMENT
STATE OF FLORIDA
COUNTY OF PALM BEACH

BEFORE ME PERSONALLY APPEARED SCOTT MASSEY WHO IS PERSONALLY KNOWN TO ME, OR HAS PRODUCED AS IDENTIFICATION, AND WHO EXECUTED THE FOREGOING INSTRUMENT AS PRESIDENT OF SEMINOLE IMPROVEMENT DISTRICT, AN INDEPENDENT SPECIAL DISTRICT OF THE STATE OF FLORIDA, HEREBY ACCEPTS SUCH INSTRUMENT AS SUCH OFFICER OF SAID DISTRICT, AND THAT THE SEAL AFFIXED TO THE FOREGOING INSTRUMENT IS THE DISTRICT SEAL OF SAID DISTRICT AND THAT IT WAS AFFIXED TO SAID INSTRUMENT BY DUE AND REGULAR DISTRICT AUTHORITY, AND THAT SAID INSTRUMENT IS THE FREE ACT AND DEED OF SAID DISTRICT.

WITNESS MY HAND AND OFFICIAL SEAL THIS 18th DAY OF July, 2017.

MY COMMISSION EXPIRES: 6-30-2020

Lynn Lo Brutto
NOTARY PUBLIC STATE OF FLORIDA

PRINT NAME: Lynn Lo Brutto
COMMISSION NO. FF 969599

MINTO PBLH, LLC SEMINOLE IMPROVEMENT DISTRICT MORTGAGEE'S JOINDER AND CONSENT CITY OF WESTLAKE SURVEYOR'S SEAL